

Representative only, some models may vary in appearance.

Commercial LOW BOY

FEATURES

- **Fan Control Switch** - for continuous fan operation.
- **Large external front clean out** - for easy cleaning.
- **Clean out** - sealed from blower compartment (no soot to spread).
- **Easy Access** - control panel.
- **Sight Glass/View Port** - (some models only)
- **Furnaces** - are available with your choice of high efficiency burners. (Burners ordered and shipped separately)
- **"Easy Access" heat exchanger** - manufactured from heavy gauge steel.
- **Multi-Speed Direct Drive Motors** - permanently lubricated for long life performance.
- **Heavy-duty insulated cabinet** - for quiet operation.
- **Precision balanced blower** - ensures quiet, efficient air distribution.
- **Raised cabinet base** - allows air to circulate under the cabinet. Eliminates dampness.
- **Efficient** - Up to 81.5% AFUE.
- **Warranty** - Limited lifetime on heat exchanger, five(5) years on burner and most other parts.

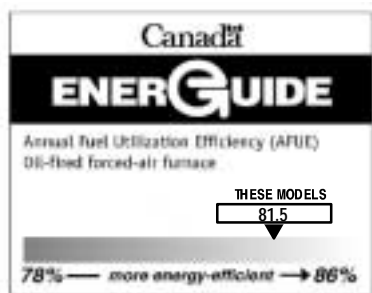

FURNACE SPECIFICATIONS

Model:	OLR210		
Rating and Performance			
Firing Rate	1.20	1.35	1.50
Input (BTUh)	168,000	189,000	210,000
Heating capacity, (BTUh)	138,000	155,000	171,000
Minimum--maximum Temperature Rise	65° - 85° F		
Beckett Burner, (3450 RPM) Chimney Installation	AFG- F6 (tube insertion 2 ⁷ / ₈ ")		
Low firing rate baffle	No		
Static disc. model	2 ³ / ₄ #3383		
Nozzle (Delavan)	1.00-70W	1.10-70W	1.25-70W
Pump pressure (PSIG)	145	150	145
Combustion air adjustment (band/shutter)	1/3	1/5	1/7
Riello Burner, Model 40 Chimney Installation	F5 (tube insertion 3 ⁹ / ₁₆ ")		
Nozzle (Delavan)	1.00-70W	1.10-70W	1.25--70W
Pump pressure (PSIG)	145	150	145
Combustion air adjustment (turbulator/damper)	2.5/2	4/2	4/4
Electrical System			
Volts -- Hertz -- Phase	115--60--1		
Operating voltage range	104 - 132		
Rated voltage Amp	15.7		
Minimum ampacity for wiring sizing	18.1		
Max. fuse size (Amps.)	20.0		
Blower Data			
Blower speed @ 0.25" WC static pressure	Md-High	High	High
Blower speed @ 0.50" WC static pressure	High	High	N/A
Motor (HP) / number of speeds	3 ³ / ₄ HP / 4 speeds		
Blower wheel size (in.)	12 x 10		
Filter quantity and size	(2) 16 x 20		
Weight (Lbs.)	240		

BLOWER PERFORMANCE DATA (Air delivery - CFM with air filter)

Model No.	OLR210	
	External Static Pressure with Air filter	
Speed	0.25	0.5
Med-Hi	1950	N/A
High	2050	1900

NEW MODEL NUMBER IDENTIFICATION GUIDE

MODEL NUMBER	O	L	R	210	F	19	#
FUEL O = Oil							REVISION AIR FLOW 19 = 1900 CFM
PRODUCT GROUP U = Upflow H = Horizontal T= Upflow/Horizontal L= Lowboy							SUPPLY PLENUM SIZE A = 20 x 20 D = 19 x 20 B = 24 x 24 E = 19 x 24 C = 21 ¹ / ₈ x 21 ¹ / ₂ F = 2- x 24 G = 22 x 30
SERIES F = Front Breech R = Rear Breech							INPUT, MBTUH

DIMENSIONS

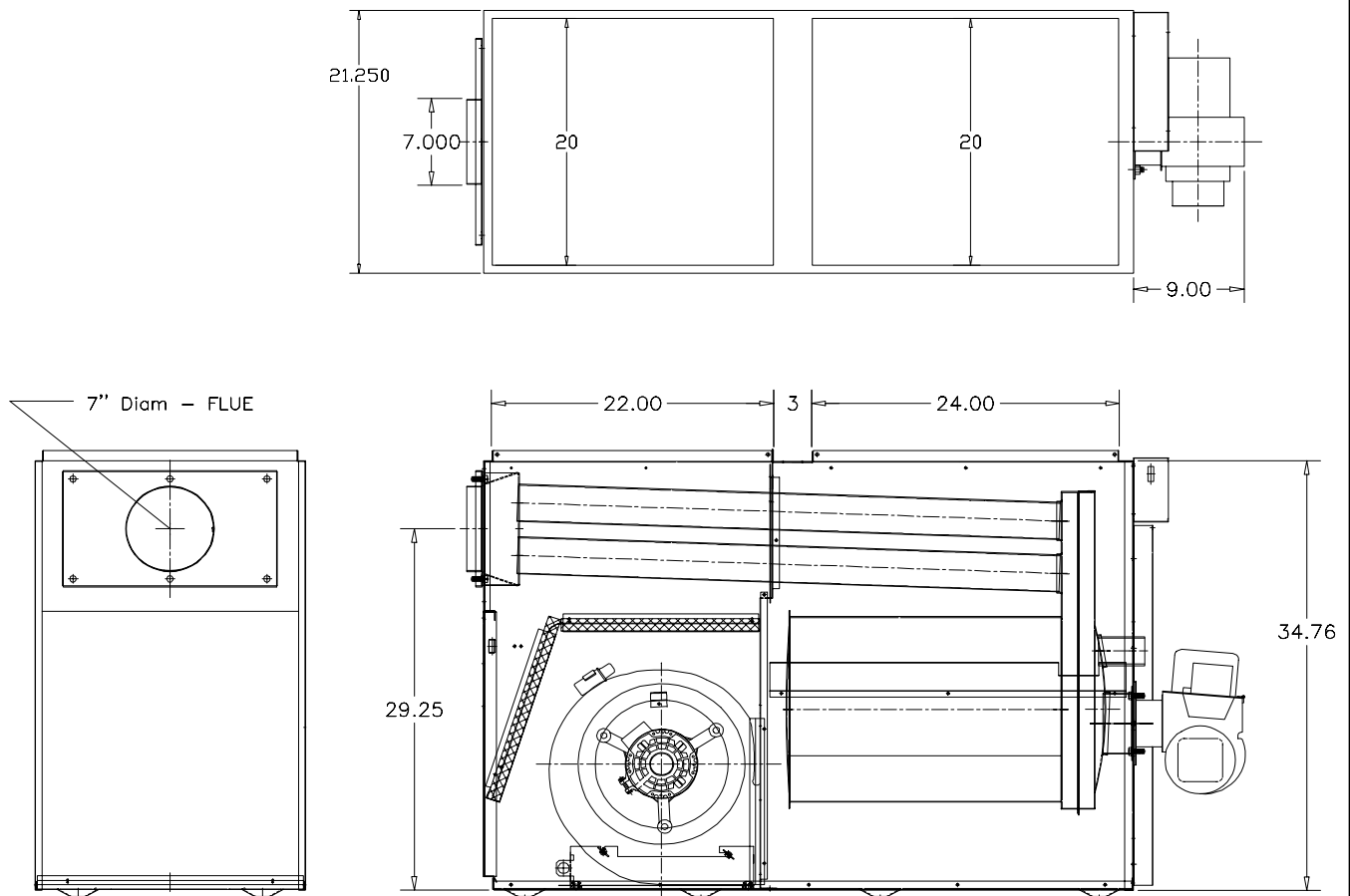

ALL DIMENSIONS IN INCHES

27-11-35

Representative only, some models may vary in appearance.

Minimum Installation Clearances from Combustible Materials		
LOCATION	APPLICATION	OLR210
Sides	Left of right	6"
	Other side left or right	1"
Back	Furnace	6"
Top	Furnace or plenum	1"
	Horizontal warm air duct within 6' of Furnace	1"
Bottom	Furnace - combustible floor	0"
Flue Pipe	Horizontally or below flue pipe	9"
	Vertically above flue pipe	9"
Front	From burner	24"

ACCESSORY DESCRIPTION	
Accessories Model No	Description
N03G012	Nozzle, Oil Burner, Delavan, 1.00 GPH/70° W
N03G013	Nozzle, Oil Burner, Delavan, 1.10 GPH/70° W
N03G024	Nozzle, Oil Burner, Delavan, 1.25 GPH/70° W
N01J045	Beckett AFG-F6 Oil Burner (Shipped with Nozzle 1.25 - 70° W)
N01F040	Riello 40-F5 Oil Burner (Shipped with Nozzle 1.25 - 70° W)